

"Tivoli Congress Hall"

- | | | |
|----|--------|-----------------------------------|
| 1 | 18 kvm | Fresenius Medical Care |
| 2 | 12 kvm | Terumo BCT |
| 3 | 9 kvm | INFOMED |
| 4 | 9 kvm | Kaneka |
| 5 | 9 kvm | Pentracor GmbH |
| 6 | 6 kvm | medicap clinic GmbH |
| 7 | 9 kvm | MILTENYI Biotic |
| 8 | 9 kvm | B. Braun Avitum |
| 9 | 12 kvm | Asahi Kasei Medical Co., Ltd. |
| 10 | 6 kvm | Alexion Pharma Nordics AB |
| 11 | 12 kvm | NIKKISO |
| 12 | 6 kvm | Glycorex Transplantation AB |
| 13 | 6 kvm | herapeutic Apheresis and Dialysis |
| 14 | 6 kvm | |
| 15 | 6 kvm | BAXTER A/S |

With Build-up
With Build-up
With Build-up

With Build-up
With Build-up

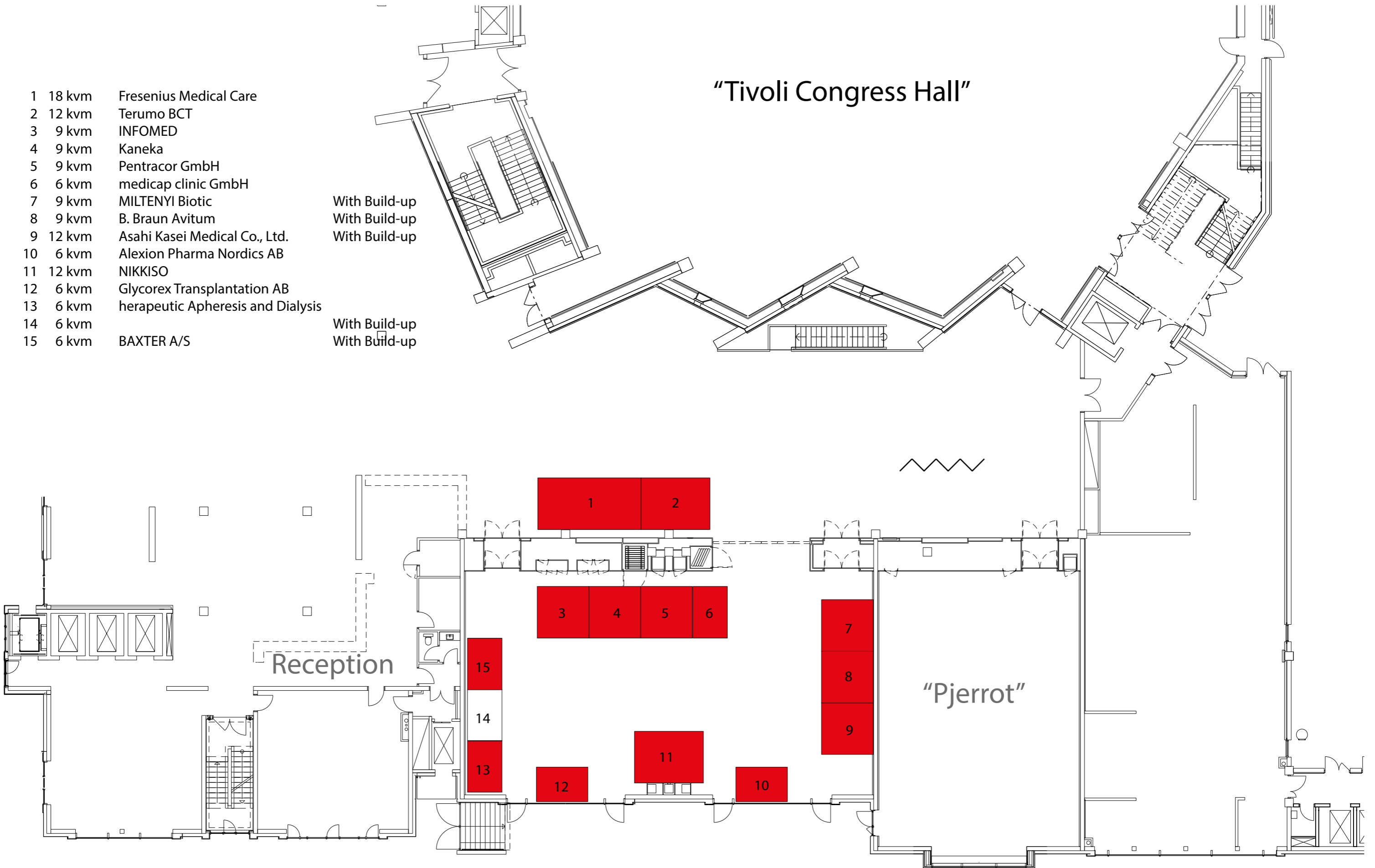

<p>Tivoli Congress Center</p> <p>ISFA 2017</p> <p>Tegn. 31-03-17</p>	<p>Standplacering 1:200</p> <p>Scanex • Ursusvej 6 • Skovby • DK-8464 Galten • 8754 1100</p>
---	--